



Clarks Neck Volunteer Fire Department

Pre-Incident Plan Data Sheet

County: Pitt or Beaufort

1750 GPM ea

0005
2 units

Date of Inspection: 1-09-2010 Committee Officer: Chief Bryan Dixon Sr.

Committee Members: Luther Bailey, William Colfield, Jim Evans, Ade Evans, Randy Jones

Location Information

Street Address: 6023 Clark's Neck Rd. Nearest Cross Street: CNR + Marva Drive

Facility / Business Name: Clarks Neck Mini Storage (Pope Enterprises)

Facility Phone Number: (252) 946-9184

Business Owner: Groell Pope Phone Number: () Mobile Number: ()

Operating Information and Access

Emergency contacts and titles with phone numbers:

Name: Title: Contact Number:

Name: Title: Contact Number:

* If more room is required for emergency contacts, please use the back of this form.

Operating hours: Open: Closed: N/A

Primary access: Electrical gate off Clarks Neck Rd.

Side 1 for plan purposes:

Key box: Yes ☒ No Key box location:

Exterior access concerns: ☒ Yes ☐ No Locations: Fenced in

Obstructions to aerials: Yes ☒ No Locations:

Exterior door concerns: Yes ☐ No Locations: N/A

Interior roof access: Yes ☒ No Locations:

Occupancy

Overall occupancy:

High fire load: ☒ Yes ☐ No Locations:

Life safety concerns: N/A

Evacuation assembly plan: Yes ☒ No Assembly point location:



Clarks Neck Volunteer Fire Department

Pre-Incident Plan Data Sheet

Hazards

Trash and waste hazards: _____

Incinerator or compactor inside: ___ Yes ☒ No Locations: _____

Incinerator or compactor chutes: ___ Yes ☒ No Locations: _____

Chutes sprinkled: ___ Yes ☒ No

Outside compactors or dumpsters: ___ Yes ☒ No Locations: _____

Compactors or dumpsters attached or exposed to the interior: ___ Yes ☒ No

Hazardous Materials present: ___ Yes ☒ No

Location of MSDS sheets: _____

Hazardous Material inventory attached: ___ Yes ☒ No

Location for use in emergency: _____

Materials reactive with air, water, or other materials present: ___ Yes ☒ No

Type of materials: _____

Typical location: _____

Radioactive materials present: ___ Yes ☒ No

Typical location: _____

Process hazards present: ___ Yes ☒ No

Typical location: _____

Construction

Number of stories: 1 Number of basements / full or partial: 0

Length: 200' + 20' Width: 20' Height: _____ of each floor.

** If more room is required for clarification of each floor, please use the back of this form.*

Penthouse: Yes ___ No ☒ Occupancy: _____

Roof covering: Tile (clay, cement, slate, etc.): ☐; Wood Shingles (treated / untreated): ☐; Metal: ☒;

Composite Shingle (asphalt): ☐; Built Up: ☐; No Roof: ☐; other: _____

Roof construction: _____ Trusses: ___ Yes ☒ No

Floor construction: _____ Trusses: ___ Yes ☒ No



Clarks Neck Volunteer Fire Department

Pre-Incident Plan Data Sheet

County: Pitt or Beaufort

Construction (continued)

Wall construction: Metal / Vinyl

Construction type: Fire Resistive: ☐ Unprotected Non-Combustible: ☐ Protected Ordinary: ☐ Protected Wood Frame: ☐
Heavy Timber: ☐ Protected Non-Combustible: ☐ Unprotected Ordinary: ☐ Unprotected Wood Frame: ☐

Combustible concealed spaces: ☐ Yes ☒ No Location: _____

Interior fire barriers and walls: ☐ Yes ☒ No Locations: _____

Wall penetrations: ☐ Yes ☒ No Locations: _____

Openings protected by: ☒ Doors ☐ Shutters ☐ Sprinklers ☐ No protection

Interior stairs: Number: _____ Location: N/A

Obstruction to stairways: N/A

Elevators: Number: _____ Location: _____

Area served – full or partial: _____

Fire service mode: ☐ Yes ☐ No Elevator key location: _____

Elevator controls location: _____

Unprotected vertical openings: ☐ Yes ☐ No Type and Locations: _____

Water Supply

Primary water supply: _____

Test results: Location: _____ Date: _____

Static pressure: _____ Residual pressure: _____ Flow rate: _____

Alternate supplies:

Private supply: ☐ Yes ☐ No Type: ☐ Gravity tank; ☐ Other tank; ☐ Cistern; ☐ Reservoir; ☐ Process system;

☐ Other: _____

Fire Pump: ☐ Yes ☐ No Supplied by: ☐ Public supply; ☐ Private supply

Start-up: ☐ Automatic ☐ Manual Number of pumps: _____



Clarks Neck Volunteer Fire Department

Pre-Incident Plan Data Sheet

County: Pitt or Beaufort

Water Supply (continued)

Location of pumps: _____

On-site hydrants: ___ Yes ___ No Supplied by: ☐ Public supply; ☐ Private supply

Size of outlets and threads: _____

Location of hydrants: _____

Hydrant Flow Rate(s):

Red (500gpm or less) ☐; Orange (500gpm to 1000gpm) ☐; Green (1000gpm to 1500gpm) ☐; Blue (1500gpm or greater) ☐

Which system supplies what protection systems: _____

Nearest large volume water supply (greater than 2000 GPM): Transfer Creek at bridge on Clarks Neck Rd.

Needed fire flow calculations:

Largest single area: _____

Needed Fire Flow

Building or Area	Area Measurements			Hazard Factors: Low, Moderate, High Severe			Total Flow Needed
	Length	Width	Height	Fire Load Factor	Life Hazard Factor	Exposure Factor	



Clarks Neck Volunteer Fire Department

Pre-Incident Plan Data Sheet

County: Pitt or Beaufort

Protection System

Fire alarm system: ___ Yes ☒ No Locations: _____

Annunciator location: _____

Type of alarms: _____

Extent of coverage: _____

Monitored system: ___ Yes ___ No Fire alarm company: _____

Phone number: _____

Detector type and power supply: Smoke: ☐; Heat: ☐; Battery: ☐; Hardwire w/ Battery Backup: ☐

Carbon Monoxide: ☐; Combination: ☐; Plug In: ☐; Plug In w/ Battery Backup: ☐

Sprinkler system: ___ Yes ☒ No Location of the FDC: _____

Size of FDC threads: _____

Type of system: Wet Pipe: ☐; Dry Chemical System: ☐; Halogen System: ☐; Class K System: ☐;

Dry Pipe: ☐; Foam System: ☐; CO2 System: ☐; Standpipes: ☐

Extent of coverage – full or partial: _____

Areas protected (if partial): _____

Location of main valve: _____

Location of sectional valves: _____

System coverage plan at valves: ___ Yes ___ No

Standpipe and inside hoses: ___ Yes ☒ No

Combined with sprinkler system: ___ Yes ___ No

FDC same as for sprinkler system: ___ Yes ___ No

Location of FDC: _____

Size of FDC threads: _____

Type of standpipes: _____

Extent of coverage – full or partial: _____

Outlet locations: _____

Outlet size and type: _____



Clarks Neck Volunteer Fire Department

Pre-Incident Plan Data Sheet

County: Pitt or Beaufort

Protection System (continued)

Special protection systems: ___ Yes ☒ No

Type of systems: _____

Locations: _____

Extent of coverage – full or partial: _____

Utilities

Y/N	Service	Shutoff location
N	Natural Gas	
N	LP-Gas	
N	Fuel Oil	
Y	Electric	Front of building A (A/B corner)
N	Emergency Power	
	Heating	
Y	Water	
	Hot Water	
N	Steam	
Y	A/C and ventilation	Window unit building A
N	Specialty gas*	
N	Specialty gas*	

* Record type of gas

Occupant concerns for utilities: ___ Yes ☒ No

Responsible contact: _____

Process concerns for utilities: ___ Yes ___ No

Responsible contact: _____

Comments: _____



Clarks Neck Volunteer Fire Department

Pre-Incident Plan Data Sheet

County: Pitt or Beaufort

Exposures

Exposure Number	Separation (ft)	Life Hazard	Fire Load	Construction	Sprinkled	Priority (low = 5)
E1	25'		High	Metal		1
E2	25'		"	"		1

Other exposure concerns: _____

Special Resource Consideration: _____

Confined Spaces: ___ Yes ☒ No Locations: _____

Remarks:

☐ If more room is required for notes, please use the back of this form.



Address: 6023 Clarks Neck Road

Name: Pope Enterprises (Clarks Neck Mini Storage)

Pre-Plan #: _____

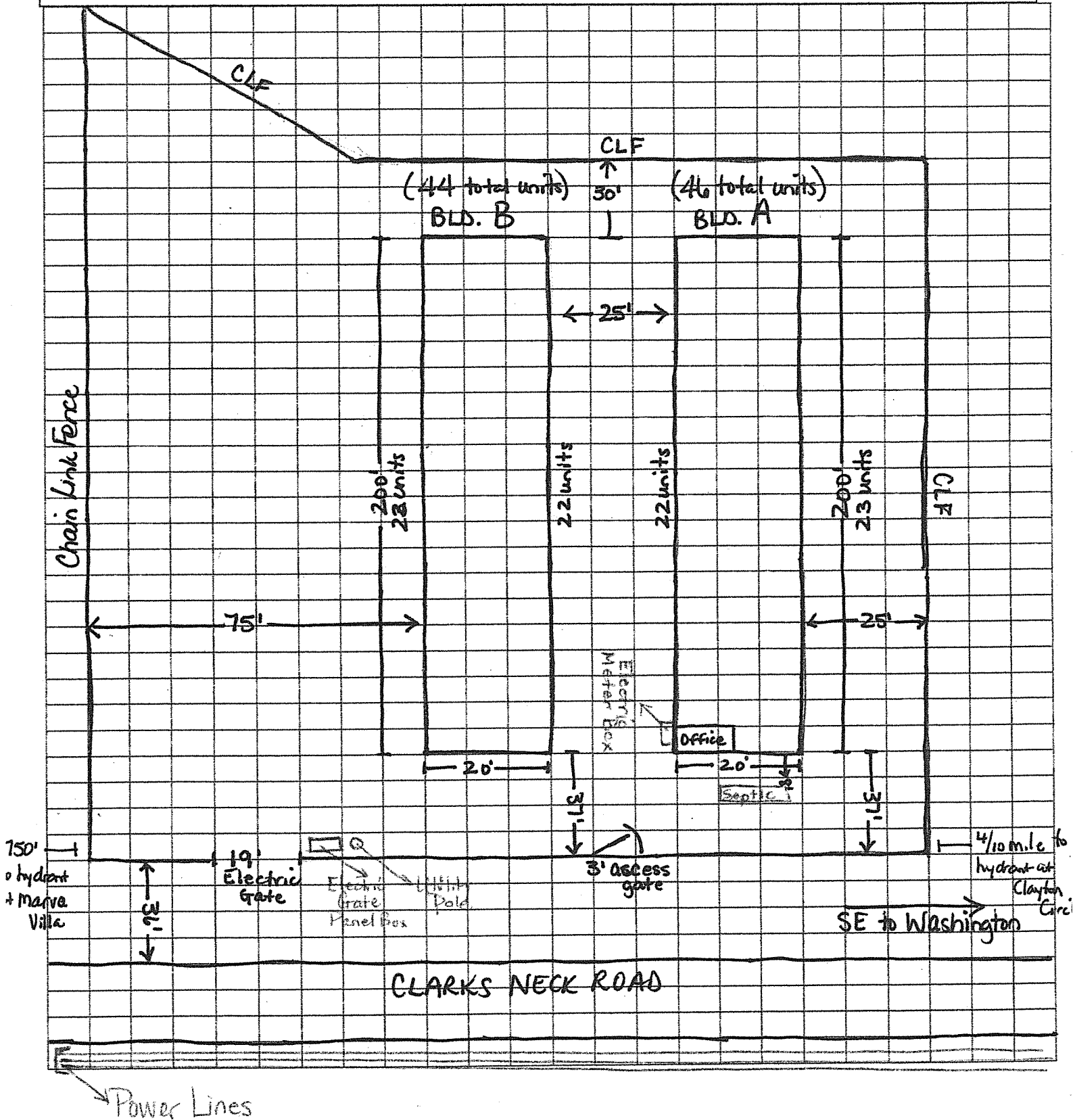

Structure Name Clarks Neck Mini Storage Bldg "A" & "B" Same for ea.
 Structure Address 6023 Clarks Neck Rd.

Length	Width	Sq Ft	Sq Root	X 18	X construction type	GPM sum 1	X Occupancy	GPM sum 2
200	20	4000	63.25	1138.42	0.6	683.05	1	683.05

Exposure % add	Exposure add GPM	Exposure per side (75% max) Total Side A	Exposure per side 75% max Side B	Exposure per side 75% max Side C	Exposure per side 75% max Side D	Total GPM with exposures
25%	170.76		129	0	0	812.05
19%	129.78					
14%	95.63					
9%	61.47					
75%	512.29	Total A, B, C, D				
	MAX	129				

Column F
Fire Resistive 0.6
Non-combustible 0.8
Ordinary 1
Wood Frame 1.5

Column H
.75 if Mostly non-combustible contents
.85 if Limited combustibles (apartments, churches, schools, hospitals)
1.0 if Mostly combustible (restaurants, sheds, garages)
1.15 if Free burning contents (post offices, horse stables, feed mills, repair garages, ag storage)
1.25 if Rapid burning (aircraft hangers, tires, flammable liquids, wood working)

Column J, K, L and M
If up to 10 feet add 25% per side
If 11 to 30 feet add 19% per side
If 31 to 60 feet add 14% per side
If 61 to 100 feet add 9% per side

Round off to nearest 250 GPM for flows less than 2500 GPM the nearest 500 GPM over 2500 GPM

Total GPM with exposures	Add 50% for each floor above ground floor	# of floors	Total to add for floors above	Sub-total with floors added	If wood shingles on roof add 500 GPM
750.00	375	0	0.00	750.00	0
					750.00

FIRE FLOW NEEDED GPM
750.00

Structure Name Clarks Neck Mini Storage Bldg "B"
 Structure Address 6023 Clarks Neck Rd.

Length	Width	Sq Ft	Sq Root	X 18	X construction type	GPM sum 1	X Occupancy	GPM sum 2
200	20	4000	63.25	1138.42	0.6	683.05	1	683.05

Column F
Fire Resistive 0.6
Non-combustible 0.8
Ordinary 1
Wood Frame 1.5

Column H
.75 If Mostly non-combustible contents
.85 If Limited combustibles (apartments, churches, schools, hospitals)
1.0 If Mostly combustible (restaurants, sheds, garages)
1.15 If Free burning contents (post offices, horse stables, feed mills, repair garages, ag storage)
1.25 If Rapid burning (aircraft hangers, tires, flammable liquids, wood working)

Exposure % add	Exposure add GPM	Exposure per side (75% max) Total Side A	Exposure per side 75% max Side B	Exposure per side 75% max Side C	Exposure per side 75% max Side D	Total GPM with exposures
25%	170.76		0	0	129	812.05
19%	129.78					
14%	95.63					
9%	61.47					
75%	512.29	Total A, B, C, D				
	MAX	129				

Column J, K, L and M
If up to 10 feet add 25% per side
If 11 to 30 feet add 19% per side
If 31 to 60 feet add 14% per side
If 61 to 100 feet add 9% per side

Round off to nearest 250 GPM for flows less than 2500 GPM, the nearest 500 GPM over 2500 GPM.

Total GPM with exposures	Add 50% for each floor above ground floor	# of floors	Total to add for floors above	Sub-total with floors added	If wood shingles on roof add 500 GPM
750.00	375	0	0.00	750.00	0
					750.00

FIRE FLOW NEEDED GPM
750.00